

Description

High movement (seismic) anodised aluminium/ PVC wall joint for use with a wall finish up to 16mm thick. Joint must fixed on to a concrete or masonry substrate.

Materials

Joint plate: 2mm thick preformed galvanized sheet
 Fixing strip: Mill finish aluminium
 Waterproofing membrane: X-Pruf Polyliner PVC

Supply Lengths

Joint plate: 2.44m
 Fixing strip: 3m
 Membrane: 25m
 Custom lengths can be produced to order.

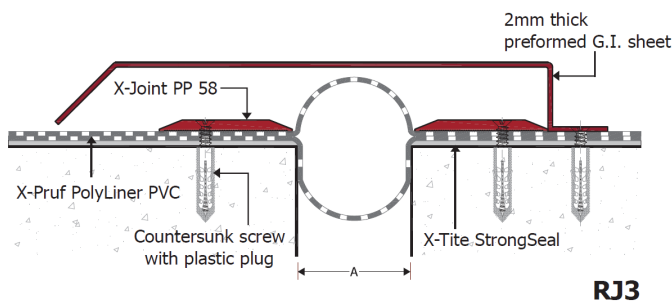

RJ3

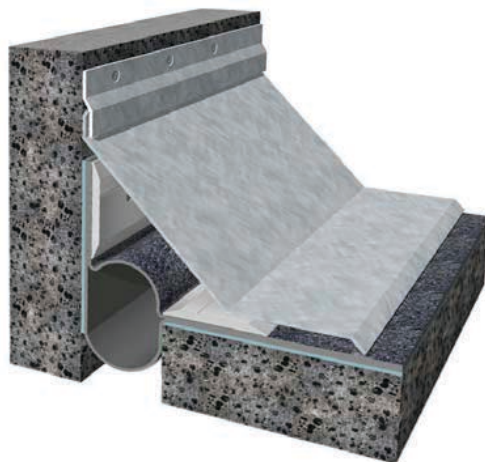

TYPE	A	*Total Movement
------	---	-----------------

Flat Profile

RJ3 50	50	50
RJ3 100	100	100
RJ3 150	150	150
RJ3 200	200	200

Corner Profile

RJ3 50	50	50
RJ3 100	100	100
RJ3 150	150	150
RJ3 200	200	200

Dimension in mm

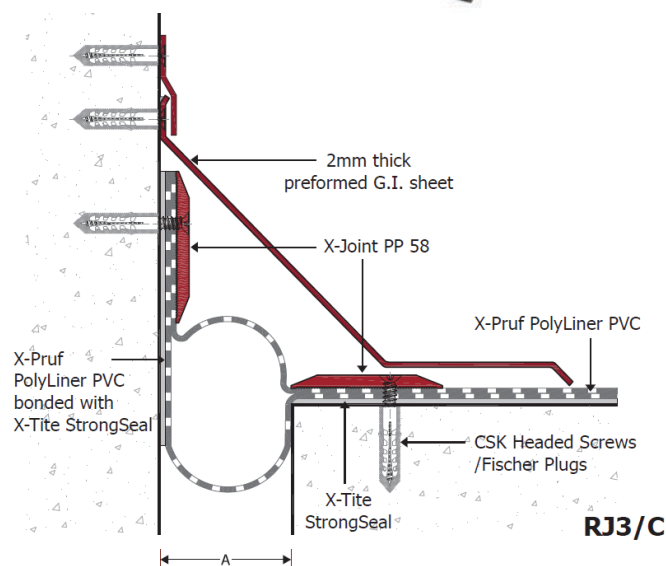

RJ3/C